



06.05.24

Good morning. I hope you have all had a lovely weekend.

As always, if you are working from home, try to follow the plan as best as you can and remember to upload photographs of your work to Seesaw so that it can be marked and we can feedback. Any extra sheets or information you may need will be included in a link in [blue](#).

Any problems, feel free to comment on Seesaw or email me on jamesl562@sch.caerphilly.gov.uk

Monday

May bank holiday – school closed

Tuesday

1 WALT: Mixed numbers to improper fractions

Activity: In today's sessions children will learn to convert mixed numbers to improper fractions and improper fractions to mixed numbers.

ACL.6

Recap previous work on fractions. Children to say what they know.

Using pictorial representation, children will understand that the same number can be represented as both an improper fraction and a mixed number. Once different pictorial representations have been shown, show children that knowing times tables can help – Multiply the whole number by the denominator, add the extra fractional parts, the denominator will remain the same

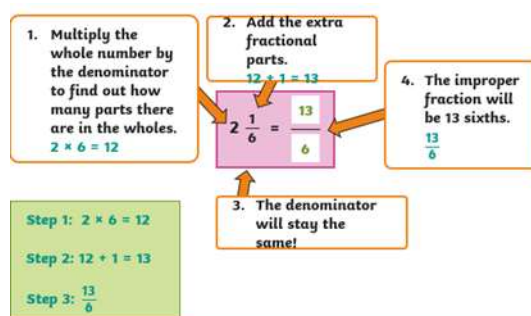



2	WALT: Alan Peat sentences	<p>Activity: In todays session children will work on Alan Peat 2 pair sentences,</p> <p style="text-align: center;">2 pairs</p> <p>Examples: Exhausted <i>and</i> worried, cold <i>and</i> hungry, they did not know how much further they had to go.</p> <p>Rule: Begins with two pairs of related adjectives. Each pair is:</p> <ul style="list-style-type: none"> • followed by a comma • separated by <i>and</i> <p>Look at the range of penguins and Whales in different scenes, what adjectives can you think to go with these pictures? In your leaning journals glue each picture in and create a 2 pair sentence that you could use in your diary entry.</p>	ACL.2
3	WALT: Explain global warming	<p>Activity: What is global warming? Discuss in groups and share. How does global warming affect the Antarctic environment?</p> <p>Each group to then carry working on their tasc creation to demonstrate global warming</p>	ECC.1

Wednesday			
9.30- Open the book assembly			
1	WALT: Subtract 2 fractions	<p>Activity: Recap adding fractions. Use images to add mixed numbers and fractions.</p> <p>Todays session will focus on subtracting fractions with the same denominator</p>	ACL.6
2	WALT: Present and answer questions on global warming	<p>Activity: Children to use this session to present their 'tasc' work on global warming in Antarctica. Use loud and clear voices and be prepared to discuss and answer questions from your team mates.</p>	EIC.1
3	WALT: Spread kindness in	<p>Activity: On today's wellbeing walk you are to find a place/space to hide your painted stone for people</p>	HIC.2



	the community	within in the community to find. Write a positive message to go with your stone for others to find and read.	
--	----------------------	--------------------------------------------------------------------------------------------------------------	--

Thursday			
----------	--	--	--

1	WALT: Subtract fractions from whole numbers.	<p>Activity: Recap work on fractions so far by taking part in a quick quiz.</p> <p>In todays session children will learn to subtract fractions from whole numbers.</p> <p>Work through the power point, have a go at using bar models and number lines to subtract fractions from whole numbers</p>	ACL.6
2	WALT: Plan a diary entry	<p>Activity: In today's session children will create a success criteria and plan for their diary entry. You will need to decide what Antarctic animal you are going to be. Using Sue Palmers skeleton work together as a class to create a wagol plan that you can use when you write your own</p>	ACL.1
3	WALT: Celebrate our friends	<p>Activity: Children to enjoy a leaving party for one of their classmates.</p>	HIC.2

Friday			
--------	--	--	--

1	WALT: Take part in physical education	<p>Activity: Children to take part in physical activity with Mr Ellis</p>	HCI.3
3	WALT: Relationship with technology	<p>Activity: Can recognise when I am spending too much time using devices (screen time)</p> <p>Can identify things I can do to reduce screen time, so my health isn't affected</p>	EIC.6



Additional Tasks

9.00- 9.30 – Registers, children settle, alternate daily, handwriting, times table, spag, mental maths

9.20-9.30- Helpwr Heddiw

9.30-10.30- Session 1- Maths –

10.30- 10.45- Break – see timetable

10.45- 11.10- Guided reading – see group list and timetable on board

11.10- 12.10 – Session 2-Literacy

12.10- 12.20- Mindfulness

12.20-1.20- Lunch – children to be taken and collected from zone (timetable on board)

1.20-2.20- Topic

2.20- 2.40- Daily Mile

2.40-3.10- Session 3 -Topic

3.10- 3.25- Class book/boost/ Newsround

3.25 – Home time